



Great Gull Crescent

Southfields, Northampton

oriordanbond
SALES & LETTINGS



GROUND FLOOR
469 sq.ft. (43.6 sq.m.) approx.

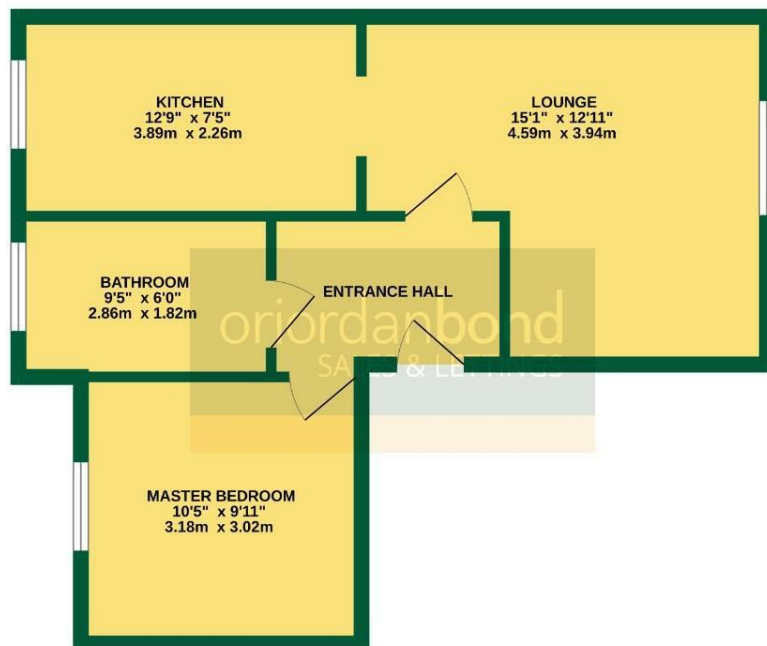

TOTAL FLOOR AREA : 469 sq.ft. (43.6 sq.m.) approx.
While every attempt has been made to ensure the accuracy of the floorplan contained here, measurements of doors, windows, rooms and any other items are approximate and no responsibility is taken for any error, omission or mis-statement. This plan is for illustrative purposes only and should be used as such by any prospective purchaser. The services, systems and appliances shown have not been tested and no guarantee is given as to their operability or efficiency can be given.
Made with Metreplan CS2020

Great Gull Crescent

Southfields

NN3 5AZ

PRICE £95,000

A modern one bedroom first floor apartment, situated in the popular area of Southfields, offered to the market with no onward chain. Provides good access to local amenities, schools and Weston Favell Shopping Centre.

The accommodation comprises secure communal entry, entrance hall, sitting/dining room, kitchen, one bedroom and a three-piece bathroom. Outside is nearby communal parking. Further benefits include uPVC double glazing. (C/470/-)

Leasehold Information: Lease Remaining - 88 Years (as of 2026) / Ground Rent - £10 per annum / Service Charge - £700 per annum

Additional information

- Council Tax Band: A
- Energy Efficiency Rating: D

Viewing

Viewing strictly by appointment – details below

Disclaimer

O'Riordan Bond Estate Agents Limited has not tested apparatus, equipment, fittings or services and so cannot verify they are in working order. The buyer is advised to obtain verification from their solicitor or surveyor.

O'Riordan Bond Weston Favell Sales

01604 784007

westonfavell@oriordanbond.co.uk

